

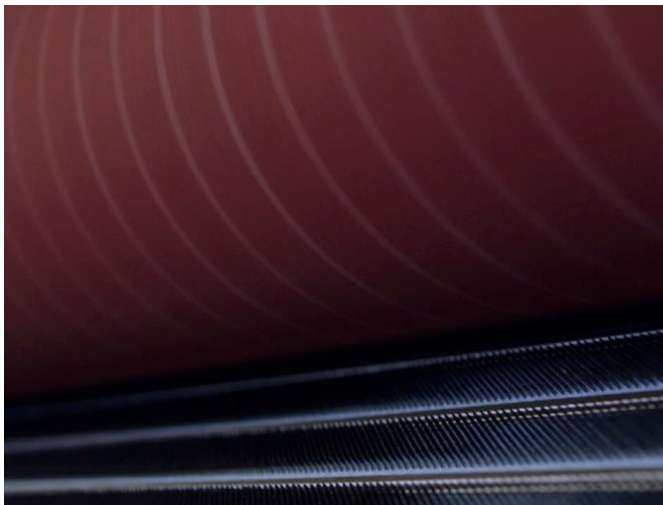

DEW – Flat grinding roller for 40" to 60" working width

The flexible flat clothing produced with the highest precision has a much more significant impact on the carding quality than the cylinder clothing. The number of neps in the card sliver is mainly influenced by the state of the flat clothing. Graf has developed the DEW equalizing roller for equalizing flat clothing economically, efficiently, and with the required precision.



Technical data

- Rating drive motor: 0.75 kW
- Motor speed: 1400 min⁻¹
- Weight of motor drive: 15 kg
- Roller speed: 800 min⁻¹
- Weight without drive: 28 kg

Product details

- Lightweight aluminum roller with feed slide and fine adjustment
- Card-specific supports for the attachment of the equalizing roller
- A traverse gear ensures even abrasion in the resharpening process as well as even wear of the emery fillet
- Maintenance-free three-phase AC motor
- Including transport truck
- CE conformity

Customer advantages

- The equalizing roller is clothed with a new emery fillet
- Activating with DEW after approx. 15 tons to get superior quality
- Flat clothings can be efficiently resharpened several times
- Noticeable improvement in the consistency of the nep values in the yarn

DEW – Flat grinding roller for 40" to 60" working width

Basic equipment

Item No 006041060

- DEW Roller with red emery filet 3M (specific length for one card)
- Card-specific adapters
- Engine
- Traverse gear
- Various mounting tools and spare part
- Transport wagon

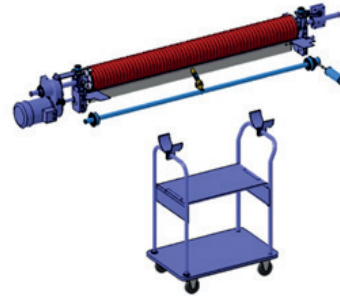

Additional equipment card-specific

For another card with **different** working width

Item No 006041061

- Additional roller with different length
- Additional adapters for additional card



For another card with **same** working width

Item No 006041059

- Additional adapters for additional card
(same adapters for DSW)



Only roller with **specific** working width

Item No. 109.555

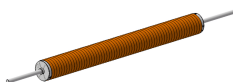

Please indicate power supply and exact card type when you order



Graf + Cie AG · Bildaustasse 6 · 8640 Rapperswil · Switzerland · Phone +41 55 221 71 11 · Fax +41 55 221 72 33 · info@graf-companies.com

www.graf-companies.com



Swiss Engineered

